

MU3



T4 Automatique



V5 Automatique



T4 Manuel



V5 Manuel



**Pinces outils DIN 6499**  
**Werkzeugspannzangen DIN 6499**  
**Tool collets DIN 6499**

**Pince de taraudage**  
**Gewindebohrzangen**  
**Tapping collets**

ESX



Fig. 1

Qualité standard  
Standard Qualität  
Standard quality

EX



Fig. 2

Qualité UP  
UP Qualität  
UP quality

ET1-



Fig. 3

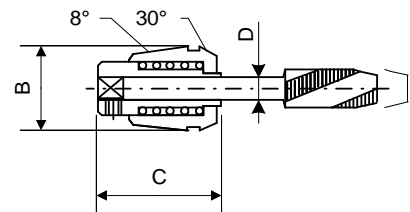
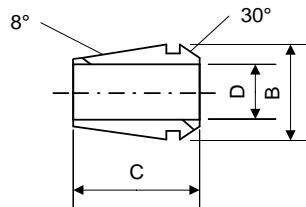

Pince Spannzange Collet		B	C	D	Fig.
ESX12	75-12300	12	19.5	1.00...7.00	1
EX12	75-12200	11.75	17.5	0.50...7.00	2
ET-1-12	selon $\varnothing$ de queue gemäss Schaftdurchmesser according to $\varnothing$ of shank	12	21.5	1.00...3.55	3

**Ecrous - Muttern - Nuts EX**

EX

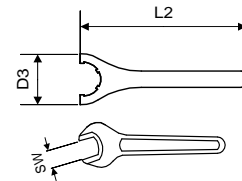
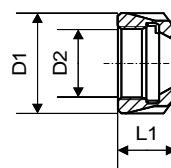
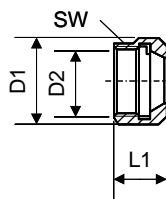

EXP

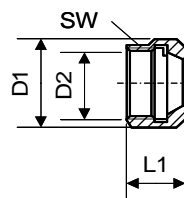

gr. / type Gr. / Typ size/type	écrou Mutter nut					clé Schlüssel spanner		
	Art.	D1	D2	L1	SW	Art.	D3	L2
EX 12	61-12730	19	M14x0.75	14	17	-	-	-
EXP 12	61-12710	16.7	M13x0.75	14	15	-	-	-

Alésages standards selon liste de prix - Standardbohrungen gemäss Preisliste - Standard bores according to pricelist

Autres alésages sur demande - Andere Bohrungen auf Anfrage - Other bores on request