

*ecopos<sup>®</sup> Machine Vices*  
***Freedom in positioning without  
risk of accident***

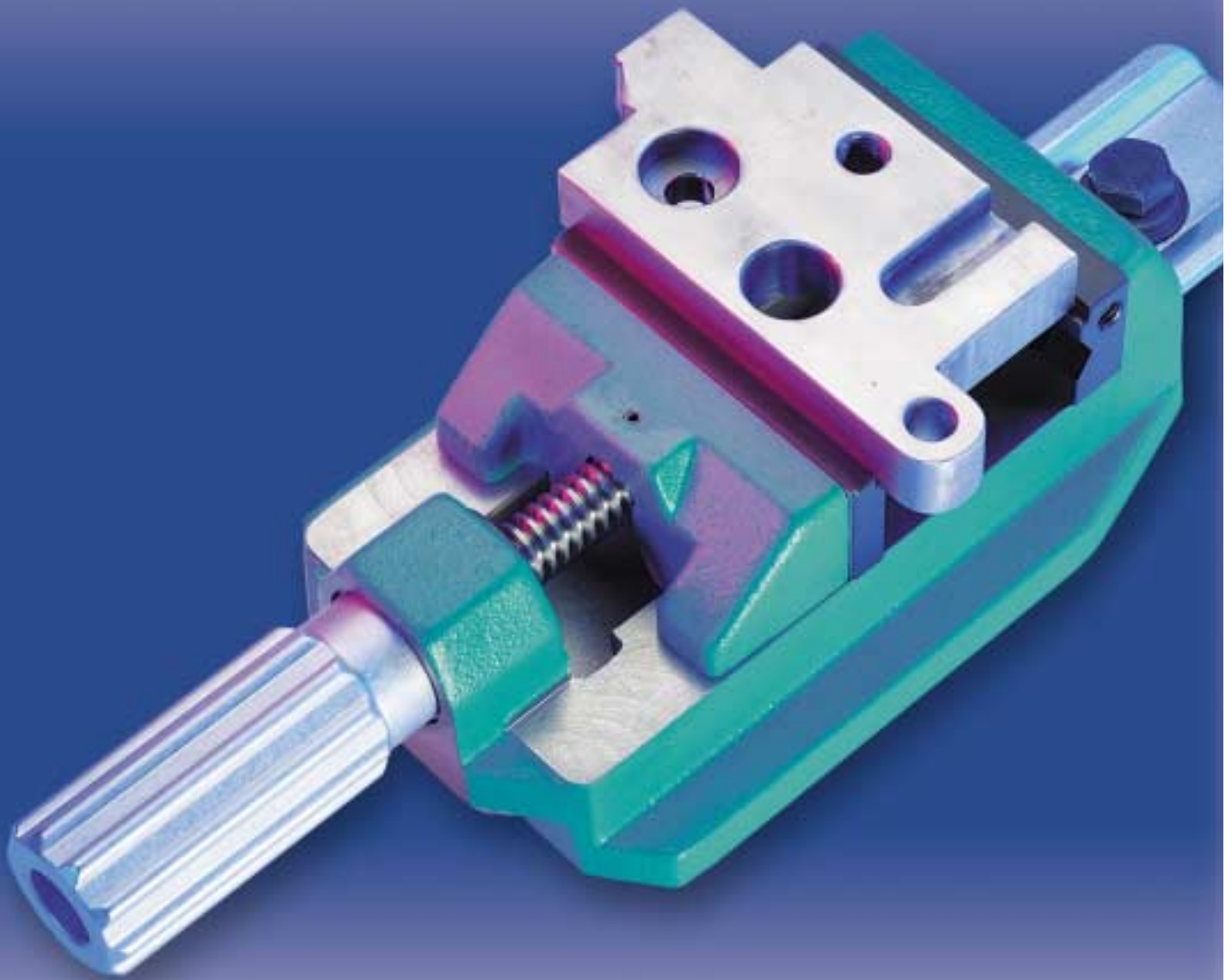

***Uniquely protected against drag spin and lift***

*Secured at the pivot point of the guide rail, the ecopos<sup>®</sup>, together with the workpiece, can be swivelled and slid to any position.*

# ecopos<sup>®</sup> machine vices with a firm grip on safety

## Total working safety

- Freely positionable workpiece that is always securely clamped (and stays so)
- One-handed manipulation
- No risk of injury, even when short of time
- For drilling and light milling work

## Fields / areas of application

- Workshop
- Production
- Metal-working
- Test workshops
- Sanitation and plumbing



**Without ecopos<sup>®</sup>**



**With ecopos<sup>®</sup>**

## Without risk of accident

No injuries, no work accidents, no consequential costs - a firm grip on accident protection, in spite of maximum speed and freedom of movement.

## Unique worldwide

Secured at the pivot point of the guide rail, the ecopos<sup>®</sup>, together with the workpiece, can be swivelled and slid to any position within a working area of 120 x 150 mm. Secure and protected against drag spin and lift.



**On every machine work-table ecopos<sup>®</sup> - set up everywhere thanks to guide rail or patented positioning clamps.**





## ecopos® - M

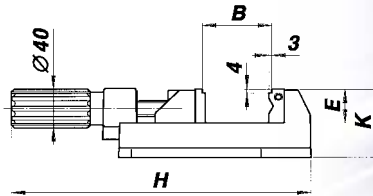
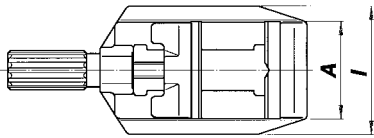

### Drilling machine vice ecopos®-M

Handy, versatile. Wide clamping range. Stepped jaws, horizontal and vertical recesses for workpieces of all shapes.

Types	Dimensions (mm)							
	A	B	E	H	I	K		
ecopos® 80-M	80	80	35	285	112	71		
ecopos® 100-M	100	100	35	305	132	71		
ecopos® 125-M	125	130	40	385	156	84		

Type	Description	Jaw width (mm)	Clamping pressure (kN)	Weight (kg)	Scope of delivery	Order No.
ecopos® 80-M	Drilling machine vice	80	--	4.5	1 prism jaw	ECM.080.000.01
ecopos® 100-M	with one prism jaw and one smooth jaw	100	--	5.6	1 smooth jaw	ECM.100.000.01
ecopos® 125-M	stepped (pc.)	125	--	11.2		ECM.125.000.01
ecopos® 80-M	Drilling machine vice	80	--	5.2	1 prism jaw	ECM.080.000.05
ecopos® 100-M	additionally with guide rail and	100	--	6.3	1 smooth jaw	ECM.100.000.05
ecopos® 125-M	1 each fixture bolt for T-slot 12 + 14 (pc.)	125	--	11.9		ECM.125.000.05

## ecopos® - R

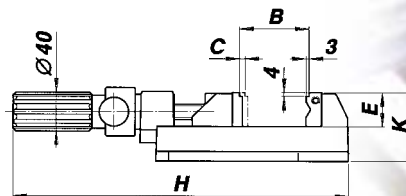
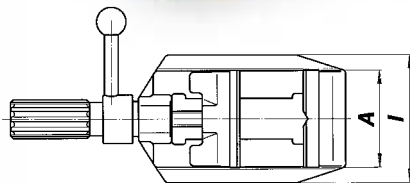

### Drilling machine vice with clamping aid ecopos®-R

Rough setting of the jaw opening with directly acting spindle. Secure and rapid clamping with engageable clamping lever. Suitable for series work.

Types	Dimensions (mm)							
	A	B	C	E	H	I	K	
ecopos® 100-R	100	100	1.5	35	340	132	71	
ecopos® 125-R	125	130	1.5	40	405	156	84	

Type	Description	Jaw width (mm)	Clamping pressure (kN)	Weight (kg)	Scope of delivery	Order No.
ecopos® 100-R	Drilling machine vice	100	--	6.1	1 prism jaw	ECR.100.000.01
ecopos® 125-R	with clamping aid, one prism jaw and one smooth jaw	125	--	11.7	1 smooth jaw	ECR.125.000.01
ecopos® 100-R	Drilling machine vice	100	--	6.8	1 prism jaw	ECR.100.000.05
ecopos® 125-R	with clamping aid, additionally with guide rail and 1 each fixture bolt for T-slot 12 + 14 (pc.)	125	--	12.4	1 smooth jaw	ECR.125.000.05

## ecopos® - S

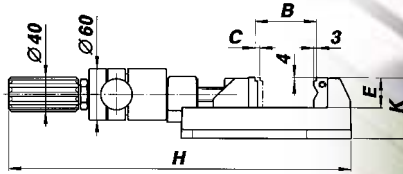
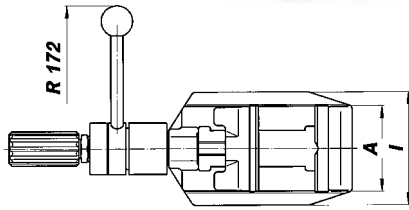

**Rapid action vice ecopos®-S**  
Optimized clamping pressure from 3 kN to 8 kN specific to type. Pre-selectable mechanical force amplification. Peak repeatability accuracy. Ideal for series work and light milling.

Types	Dimensions (mm)						
	A	B	C	E	H	I	K
ecopos® 100-S	100	95	3.5	35	393	132	71
ecopos® 125-S	125	130	3.5	40	457	156	84

Type	Description	Jaw width (mm)	Clamping pressure (kN)	Weight (kg)	Scope of delivery	Order No.
ecopos® 100-S	Rapid action vice	100	3 - 6	7.3	1 prism jaw	ECS.100.000.01
ecopos® 125-S	with pre-selectable controlled clamping force, one prism jaw and one smooth jaw (pc.)	125	3 - 8	12.8	1 smooth jaw	ECS.125.000.01

## ecopos® - P

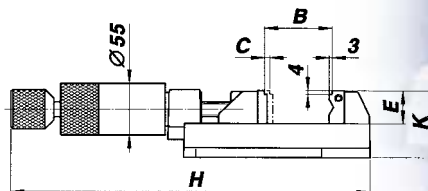
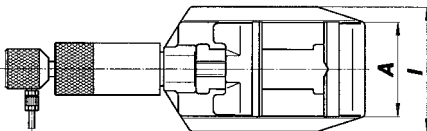

**Pneumatic machine vice ecopos®-P**  
Rough setting of jaw opening via knurled grip. Clamping pressure up to 5.5 kN pre-settable via air pressure adjustment. Hand actuation of clamping stroke via slide valve. Foot valve or programmable servo-control possible.

Types	Dimensions (mm)						
	A	B	C	E	H	I	K
ecopos® 80-P	80	75	4	35	347	112	71
ecopos® 100-P	100	95	4	35	367	132	71
ecopos® 125-P	125	130	4	40	466	156	84

Type	Description	Jaw width (mm)	Clamping pressure (kN)	Weight (kg)	Scope of delivery	Order No.
ecopos® 80-P	Pneumatic machine vice	80	0.8 - 4	6.3	1 prism jaw	ECP.080.000.01
ecopos® 100-P	with one prism jaw and one smooth jaw	100	0.8 - 4	7.3	1 smooth jaw	ECP.100.000.01
ecopos® 125-P	and 2 m air hose (pc.)	125	1 - 5.5	13.3	2 m air hose	ECP.125.000.01





## ecopos® 72-M

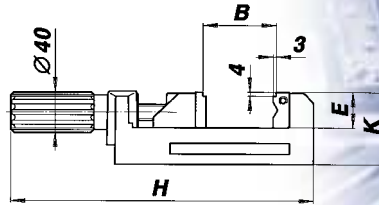
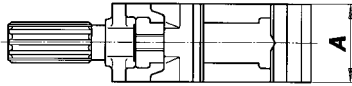

### Small machine vice ecopos® 72-M

Fine milled on four sides for use in various positions. Compact dimensions. Directly acting spindle analogous to type ecopos®-M.

Types	Dimensions (mm)					
	A	B	C	E	H	K
ecopos® 72-M	72	80		35	282	71

Type	Description	Jaw width (mm)	Clamping pressure (kN)	Weight (kg)	Scope of delivery	Order No.
ecopos® 72-M	Small machine vice with one prism jaw and one smooth jaw (pc.)	72	--	3.5	1 prism jaw 1 smooth jaw	EKM.072.000.01

## ecopos® 72-P

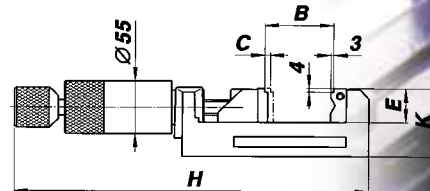
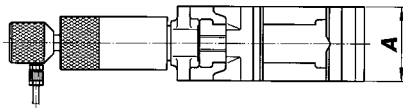

### Small pneumatic machine vice ecopos® 72-P

With pneumatic drive. Clamping pressure up to 4 kN pre-settable via pressure adjustment. Hand actuation of clamping stroke via slide valve. Foot valve or programmable servo-control possible.

Types	Dimensions (mm)					
	A	B	C	E	H	K
ecopos® 72-P	72	75	4	35	344	71

Type	Description	Jaw width (mm)	Clamping pressure (kN)	Weight (kg)	Scope of delivery	Order No.
ecopos® 72-P	Small pneumatic machine vice with one prism jaw and one smooth jaw and 2 m air hose (pc.)	72	0.8 - 4	5.3	1 prism jaw 1 smooth jaw 2 m air hose	EKP.072.000.01

Fig.	Type	Description/Application/Dimensions (mm)	For vice type						Order No.
			ecopos®-M	ecopos®-R	ecopos®-S	ecopos®-P	ecopos®-72M	ecopos®-72P	
<b>Jaw assortment</b>									
	<b>Prism jaw</b> stepped, with screws	D 35 Q 16 Z 31 Jaw width 72	◆	◆		◆	◆	ECA.072.013.01	
		D 35 Q 16 Z 31 Jaw width 80						ECA.080.013.01	
	<b>Prism jaw</b> stepped, with screws	D 35 Q 16 Z 31 Jaw width 100	◆	◆	◆	◆		ECA.100.013.01	
		D 40 Q 18 Z 36 Jaw width 125	◆	◆	◆	◆		ECA.125.013.01	
	<b>Smooth jaw</b> stepped, with screws	D 35 Q 10 Z 31 Jaw width 72	◆	◆		◆	◆	ECA.072.014.01	
		D 35 Q 10 Z 31 Jaw width 80						ECA.080.014.01	
	<b>Smooth jaw</b> stepped, with screws	D 35 Q 10 Z 31 Jaw width 100	◆	◆	◆	◆		ECA.100.014.01	
		D 40 Q 12 Z 36 Jaw width 125	◆	◆	◆	◆		ECA.125.014.01	
	<b>Precision stepped jaws</b> set 2 pc.	D 35 Q 11.5 Z 30 Jaw width 100	◆	◆	◆	◆		MSA.100.190.01	
		D 40 Q 13.5 Z 32 Jaw width 125	◆	◆	◆	◆		MSA.125.190.01	
<b>Positioning and fixture</b>									
	<b>Positioning clamps</b> incl. 2 each fixture bolts for T-slot 12 + 14 mm	For vice set up for series work. Any desired set-up positions on machine work-tables with various T-slot configurations possible.	◆	◆	◆	◆	◆	ECA.000.050.01	
	<b>Guide rail</b> incl. 1 each fixture bolt for T-slot 12 + 14 mm	Fixture via bolt in T-slot of machine work-table. Allows freedom of swivel without lift or drag spin of vice within working area of 120 x 150 mm.	◆	◆	◆	◆		ECA.000.060.01	
<b>Further accessories</b>									
	<b>Material stop</b>	For optional fixture on left, right or on both sides of vice head. Length adjustment of stop pin quick and easy via screw.	◆	◆	◆	◆	◆	ECA.000.065.01	
	<b>Foot valve</b>	Used instead of hand valve.				◆	◆	ECA.000.045.01	
	<b>Conditioning unit</b> incl. connection material	For constantly flawlessly conditioned compressed air. Clamping pressure adjustable via built-in regulator.				◆	◆	ECA.000.035.01	

ecopos® synopsis	ecopos®-M	ecopos®-M	ecopos®-R	ecopos®-R	ecopos®-S	ecopos®-P	ecopos®-M	ecopos®-P
Jaw width 72 mm						◆	◆	
Jaw width 80 mm	◆	◆	◆	◆		◆		◆
Jaw width 100, 125 mm	◆	◆	◆	◆	◆	◆		
<b>Basic body of GG 25</b>								
With inside guideway for sliding on guide rail, and outside ledge for positioner clamps	◆	◆	◆	◆	◆			
Milled sides for side set-up						◆	◆	
<b>Clamping mechanism</b>								
Thrust spindle	◆	◆	◆	◆	◆	◆	◆	
Rapid clamping aid			◆	◆				
Pre-selectable clamping pressure				◆	◆		◆	
Pneumatic drive				◆			◆	
<b>Fixture</b>								
Inside slot and outer ledge	◆	◆	◆	◆	◆			
Outside slot						◆	◆	
Guide rail	◆	◆	◆	◆	◆			

◆ standard ◆ optional

Distributor: